

OCEAN CITY REELS NOS. 1950, 1950-N AND 1950-W
(Model A)

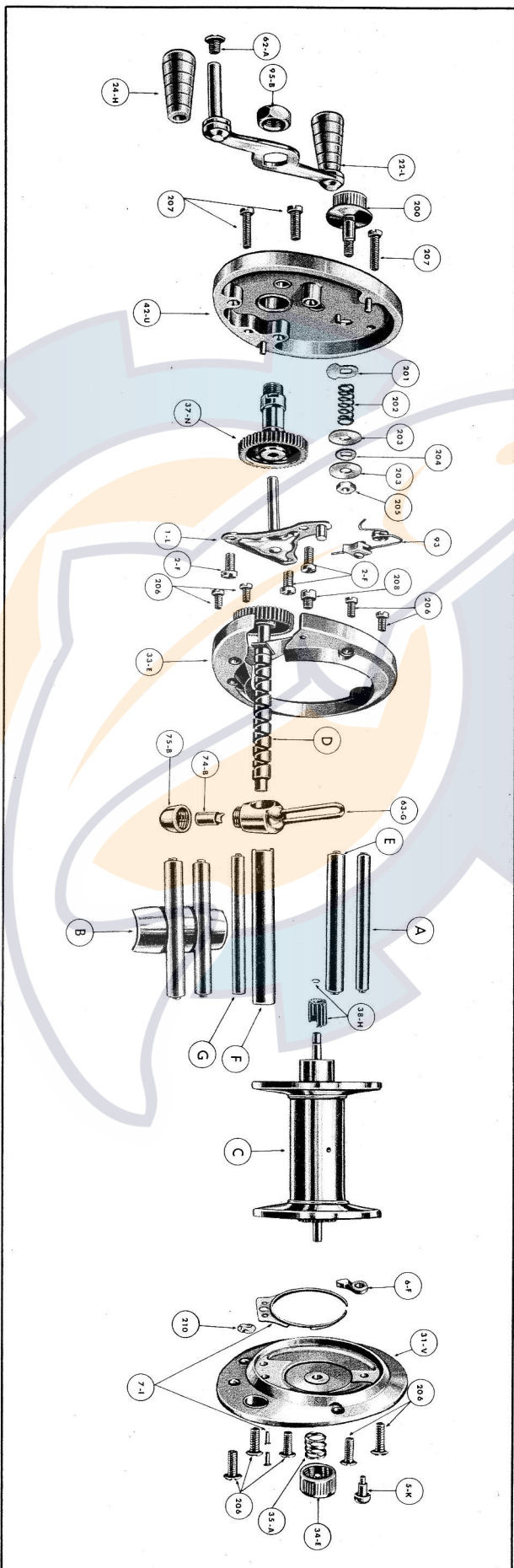

HOW TO ORDER PARTS FOR YOUR REEL—Locate the part desired in the illustration above and note part number, part name and model letter which you will find on underside of reel stand. Enclose money order, stamps or check. Our minimum charge for one order is \$3.25. Please add \$.15 on each order for return postage and insurance.

| PART No. | PART NAME | PRICE | PART No. | PART NAME | PRICE | PART No. | PART NAME | PRICE | PART No. | PART NAME | PRICE |
|----------|--|-------|----------|-----------------------------------|-------|----------|---|-------|----------|---|-------|
| 1-L | Bridge | .75 | 34-E | Left Side Oil Cap | .20 | 71-E | Worm, Complete with Gear (for No. 1950) | 1.50 | 200 | Drag Adjusting Knob | .50 |
| 2-F | Bridge Screw | .02 | 35-A | Left Side Oil Cap Spring | .04 | 71-F | Worm, Complete with Gear (for No. 1950-N) | 1.25 | 201 | Drag Cam | .05 |
| 5-K | Click Button | .12 | 37-N | Main Gear | 1.50 | 71-G | Worm, Complete with Gear (for No. 1950-W) | 1.75 | 202 | Drag Coil Spring | .05 |
| 6-F | Click Pawl | .06 | 38-H | Pinion Gear and Lock Ring | .25 | 71-H | Worm, Complete with Gear (for No. 1950-W) | 1.75 | 203 | Drag Retaining Washer | .02 |
| 7-1 | Click Spring and Rivets | .10 | 42-U | Right Side Plate | 1.50 | 71-I | Worm, Complete with Gear (for No. 1950-W) | 1.75 | 204 | Drag Regulating Washer | .02 |
| 19-0 | Frame Post (for Model No. 1950 Only) | .10 | 43-U | Stand (for Model No. 1950 only) | .50 | 71-J | Worm, Complete with Gear (for No. 1950-W) | 1.75 | 205 | Left Plate and Right Inner Post and Stand Screw | .02 |
| 19-P | Frame Post (for Model No. 1950-N Only) | .10 | 43-V | Stand (for Model No. 1950-N only) | .50 | 71-K | Worm, Complete with Gear (for No. 1950-W) | 1.75 | 206 | Right Side Plate Screw | .02 |
| 19-Q | Frame Post (for Model No. 1950-W Only) | .12 | 43-W | Stand (for Model No. 1950-W only) | .75 | 71-L | Worm, Complete with Gear (for No. 1950-W) | 1.75 | 207 | Worm Latch Screw | .02 |
| 22-1 | Handle Complete with Knobs | .60 | 44-20 | Spool (for Model No. 1950 only) | 2.00 | 71-M | Worm, Complete with Gear (for No. 1950-W) | 1.75 | 208 | Frame Post (for No. 1950 only) | .10 |
| 24-H | Handle Knob | .12 | 44-2P | Spool (for Model No. 1950-N only) | 1.75 | 71-N | Worm, Complete with Gear (for No. 1950-W) | 1.75 | 209-A | Frame Post (for No. 1950-N only) | .10 |
| 31-V | Left Side Plate (Complete with Part Nos. 5-K, 6-F and 7-1) | 1.75 | 44-2Q | Spool (for Model No. 1950-W only) | 2.50 | 71-O | Worm, Complete with Gear (for No. 1950-W) | 1.75 | 209-B | Frame Post (for No. 1950-W only) | .12 |
| 33-E | Right Side Frame Ring Only (Does Not Include part Nos. 71-E, 71-F, 71-G) | 2.25 | 62-A | Handle Knob Screw | .02 | 71-P | Worm, Complete with Gear (for No. 1950-W) | 1.75 | 210 | Worm Cushion Spring | .02 |
| | | | 63-G | Line Guide | .50 | 71-Q | Worm, Complete with Gear (for No. 1950-W) | 1.75 | | | |